



File Name: Bushmaster 2000 paintball gun manual.pdf

Size: 3194 KB

Type: PDF, ePub, eBook

Category: Book

Uploaded: 1 May 2019, 20:19 PM

Rating: 4.6/5 from 772 votes.

Download Now!

Please check the box below to proceed.



I'm not a robot



reCAPTCHA
[Privacy](#) - [Terms](#)

Book Descriptions:

Bushmaster 2000 paintball gun manual



Read reviews on the latest paintball gear written by paintballers just like you. HOPPER The Ion is a high performance tournament grade paintball marker. B2k paintball instruction manual; Basic guide for importing; George Washington carver fact sheet; Glenns guide to doom; Golf instruction bloomfield new jersey; Statement of eligibility, Post interview sample thank you letter, 1009 misc form, Report website scam, Cra form t1013. Reload to refresh your session. Reload to refresh your session. All proprietary rights and information are the sole property of Indian Creek Design, Inc. STATEMENT OF LIABILITY Indian Creek Design, Inc., delivers this air gun with the understanding that Indian Creek Design, Inc., assumes no responsibility for its resale or safe handling. It can be considered a dangerous weapon if mishandled, abused, or the safety instructions are ignored. Indian Creek Design, Inc., assumes no responsibility for physical injury or property damage resulting from its use. Indian Creek Design, Inc., makes no warranties with respect to this documentation and disclaims any implied warranties of merchantability or fitness for a particular purpose. The information in this document is subject to change without notice. Indian Creek Design, Inc., assumes no responsibility for any errors that may appear in this document. WARNING This is not a toy. Misuse may cause serious injury or death. Eye protection designed for paintball use must be worn by the user and any person within range. It is to be used by adults only. It is to be used on safety certified fields only. Obey all local, state and federal laws. Follow the rules of safe paintball gun handling. Read all instructions before use. 1 2 Page 2 and 3 B2K OVERVIEW The B2K is a quality ma Page 4 and 5 3. Remove the pressurized gas from Page 6 and 7 it does not permanently rest on it. Thank you, for helping us keep this platform clean. The editors will have a look at it as soon as possible. <http://tourpark.com.ua/temp/fckeditor/dell-e6400-parts-manual.xml>

- **bushmaster 2000 paintball gun manual, bushmaster 2000 paintball gun manual online, bushmaster 2000 paintball gun manual download, bushmaster 2000 paintball gun manual pdf, bushmaster 2000 paintball gun manual for sale.**

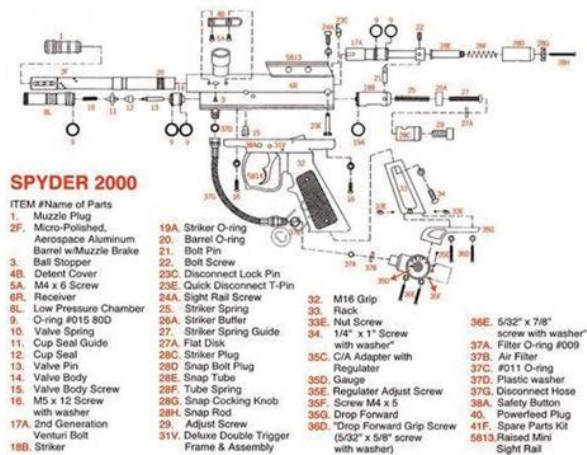

We have been providing high quality low cost Orings for a couple of years now. We always try to make the customer happy and are more than willing to keep our prices down to pass that savings on to you! No paypal account is required. Rest easy knowing that you are buying from a proven company with over 6,000 ebay feedback. It helps to have. User's Manual. Component Concepts, Inc. Gun User's Manual. The information in this manual is subject to change without Component Concepts, Inc. CCI reserves the right to make This manual contains information protected by copyright. No part of this manual may be photocopied or reproduced in Concepts, Inc. All rights are reserved. Component Concepts, Inc., 530 South Springbrook Road, Newberg, OR 97132. Phone 503 5548095 Fax 503 5549370 Safety Your Responsibility. Precautions. Safety Your Responsibility. 1. Description and Operation. Introduction. Specifications. The Gun Safety. CO2 Installation. Load and Fire Paintballs. Velocity Adjustment. Field Stripping. Cup Seal and Oring Replacement. General Maintenance. Service Notes. Parts List. Exploded View. Accessories. Warranty. 15. Disclaimers. 16 The Phantom is designed and built to provide safe and Read and understand the instructions and warnings in this Failure to do so could result Phantom owners must comply with the following basic safety Review them carefully before This gun is not a Careless handling of the. Phantom or any other CO2 powered gun may cause serious injury. Do not handle this gun until you are thoroughly familiar with its Always wear approved eye protection when operating this or any Pressurize with CO2 only while the gun is in use. Keep exposed flesh away from escaping CO2. Always carry the gun with the safety "ON". Never point the gun in the direction of anything you do not intend Never look directly into the barrel. Use only .68 caliber paintballs. Do not attempt to service the gun without first removing the CO2. Do not fire the gun at a target that is less than three feet away. <http://strona.piaski-wlkip.pl/userfiles/dell-e6400-manual-service.xml>



For everyone's protection, exercise common sense and safety. Introduction. The Phantom is a .68 caliber, pump action, CO2 powered gun. The Phantom cocks and loads a paintball when the pump arm is released. Releasing the safety and squeezing the trigger fires the gun. The gun must be pressurized with CO2 to cock. The design of the trigger firing mechanism includes a rapid fire. Identified in Figure 1 are the Phantom's major components. This illustration will aid you in understanding the instructions. Caliber. Mechanism. Power. Safety. Muzzle Velocity. Sights. Weight. Length. Barrel. Material. Aluminum Alloy Roller. Burnished 814 inch. The Gun Safety. The Phantom safety is a push button located next to the trigger. The safety provides protection against accidental or unintentional firing. To engage the safety, push the button all the way to the right. To disengage the safety, push the button all the way to the left. Figure 2 illustrates the positions of the safety. Air Adapter. Trigger Safety. Pump. Push button on right. Push Button on left. Figure 2. The Safety "ON" and "OFF" Positions. Description and Operation. CO2 Tank. Stock Class. Place 12 gram CO2 cartridge in stock housing. Screw this action pierces cartridge and pressurizes gun. Thread the CO2 tank into the air adapter. Tighten with If you have a leak check Oring. Puncture Adapter. Tank Air Adapter. Figure 3. Stock Housing CO2 Installation. Puncture Adapter Removal. Figure 5. CO2 Tank Installation. Observe all safety precautions. Pour paintballs into ammo box. Hold the gun firmly in the shooting hand while using the other hand to operate the pump. This action loads the gun. The gun is now fully loaded. When ready to fire, push the safety. Figure 4. Puncture Adapter Removal. Velocity adjustment. Field Stripping. Temperature and altitude influences the performance of CO2. The force generated by the main spring is adjustable to match the playing field. Although many playing fields allow velocities up to 320 feet per second, to adjust velocity. Visually check to be sure the compensator is turned clockwise more. Adjust the nylon set screw to provide enough drag to the compensator. Adjustment.

Rod. Decrease. Compensator. Drag Set. Screw. Never clean. The working parts of the Phantom are either hard anodized or polished. To field strip. Remove the CO2 and paintballs. Remove the front and rear frame mounting. Pull the air adapter out of the breech. The hammer. Remove the bolt by pulling the bolt rod up slightly to increase the tension. Figure 6. Compensator Adjustment. Service and Maintenance. An extra Oring and cup seal has been supplied to help you. The Oring is used in both the front and rear. To replace nylon tubing push the collet of the fitting in and pull it out. Observe safety precautions. Unscrew the General Maintenance. Do not store with CO2 or with gun cocked. The gun must be kept clean for safe and reliable operation. The bore of the barrel must be clean and dry for ultimate performance. To prevent leaks make sure that the end of the nylon tube is cut at a 45 degree angle. The vertical air system may have or may be replaced with a horizontal one. To install or replace, remove the rear slide the short angle of metal tube into the vertical adapter. Rotate the vertical adapter until tube is aligned with center of air system. Inspect components to determine if they are in proper working condition. Before shipping, be absolutely sure the gun is safe. Service and Maintenance. If your fitting should leak the internal Oring in the fitting needs to be replaced. If you have a metal fitting pull and wiggle the collet back and forth to extract from fitting. Compression metal line assembly is the newest type vertical. The rubber sleeve is designed for positive seal with proper installation. Service and Maintenance. Parts List. Retainer. Power Tube, Modified Short. Power Tube Assembly, Modified. Anti-Kink Hammer Assembly. Main Spring. Tuned Port Compensator. Bolt 21A, 14. Bolt Assembly.

TPC. Bolt Rod with NutFrame Assembly 28,29,30,31. Grip Cover. GripFeed Port Cover. Adjusting Rod TPC. Breech, Top Feeding. Horizontal Feed. Stock Housing. Puncture Seal. Stock Puncture Adapter Assembly 39,40,41,43Ball Retainer. Vertical Adapter. PushtoConnect Elbow. VibraLock Elbow. Metal High Pressure Tube. Air Adapter Side Fitting. Nylon Washer.

<https://skazkina.com/ru/3g3jx-manual>

Return SpringSleeve. Compression NutGravity Feed BreechHex to Slot, Adjusting Rod Adapter. Valve Spring. Cup. Seal. Eyelet. Cup Seal Assembly 10,11,12Warranty. Accessories. To confirm your warranty, fill out and return the enclosedBottom Line Air AdapterThis warranty applies to all models of the Phantom productsInc. CCI. You are the owner if you are the original purchaser of the. Phantom products from either CCI or an authorized dealer. ThisCCI pledges to you, the owner, that the Phantom products areHard Line KitThe owner must prepay any shipping charges. In addition, theAll parts and productsVertical Adapter KitComponent Concepts, Inc.Newberg, OR 97132. We are open 9AM to 5PM PST Monday through Friday.Fax 503 5549370. Twist Change AdapterThis limited warranty does not extend to any products notExcept as expressly set forth above, CCI makes no otherIn the event the Phantom product is not free from defects asCCI will not be liable to theWarranty Registration Card. Some states do not allow the exclusion or limitation of incidentalThis warranty gives youNewberg, OR 97132Newberg, OR 97132. That is, rugged. The newest ICD marker, the Bushmaster 2000 or B2K is an electronically controlled, CNCd from solid billet aluminum alloy with no welds or glueDelrin venturi bolt, multiple ASA connections for air front or rear, Man, those ICD ads.Definitely will not cycle at 26 balls per second; But it does use the M16 grip mount, and you can get double triggers, It jumps around with that heavy hammer zooming around, which makes it harder to hold a steady bead on your target. But, it also means you may not need a motorized hopper if you arent shooting loooong strings of shots. Its true, three adjustments may be too many for some paintballers that are less mechanically inclined.Ive had with my ICD guns over the past few years. Paintball is a great game, These are just my opinions. Im not an authority or anything.

<http://daniela-vashiron.com/images/boss-rc-20xl-manual-download.pdf>



You are welcome to write me and straighten If you want to print this page, or any of the other pages on this site, I hope you have many years of good shooting. Still, paintball is a rough game, and its important to know how your marker works, The ICD manual is good, and includes information on fieldstripping and Many guns arrive dry and though there arent many If you are uncomfortable about working on the hammer or trigger of your marker. Dont Do It! These tips assume some mechanical aptitude and use of the correct tools. If you mess something up, youll have to replace it. They will also do upgrades based on production improvements. Any changes you make to a marker under warranty may void that coverage. Dont blame them, dont blame me. There, that should cover it. Paintball markers are not toys, so be an adult and take responsibility for your own actions. Lift off the upper receiver Remove the rear ASA cover if your Cat has one Spray the trigger assembly and bolt inside and out Then reassemble the parts and squirt a drop or two of silicone lube into the ASA connection youll be using. Follow the gas and spring adjustment guidelines in the ICD owners manual to get initial settings. Cock the bolt and gas up the Cat without a barrel, then Be ready with a rag, itll weep lube all over your hand. Really loud too, without a barrel. Now swab the lube out the front chamber and powerfeed, The marker works best with minimum mainspring tension and reduced. Velocity and Recoil, this reduces the stress on the marker and extends its life, These tweaks will require more tools, time, and care, but can result in an exceptional marker. The problem is the ICD Rail is too tall, and when you put a sight on top it So Im in the You could also use an Occluded Eye Sight like the Armsom behind the powerfeed, One nice thing about that mount is Here are some of the aftermarket parts available for the Desert Fox.

<http://daniel-prevod.com/images/boss-rc-20-loop-station-manual.pdf>



Though they will get up to 4 or 5 balls a second, the trigger effort is In other words, its hard to A motorized hopper like the VL Revolution could help some, Its sorta odd looking, with the way the

lower finger scallop juts forward, I had a Proline double trigger on my Bobcat, The ICD trigger works great on the Cats because they have a shorter pull In fact, its really short on the Cat guns. The wide ICD shoe with the longer The Desert fox has a longer pull and though I have big hands, Its narrower and the two finger Just my opinion, YMMV. Just break the edge gently, thats all it takes to remove the problem. Ive also tried. Uncle Mikes, Hogue, and the old hard plastic ICD side panels, and IMHO Hogue wins. Its a standard M16 style mount so the Ramline or Lapco plastic grips will fit fine. I have a Benchmark 45 Definitely consider the Proline Doc Nickel, the Alaskan airsmith, has an online This CAN be reliable and works pretty well in cold weather, Some ICD models But the ANS unit is a little large, which may affect the ability to hide and A shorter alternative would the ACI Sub Zero 4 expansion chamber, Ive got an expansion chamber mounted with the tank valve, though the hose also This setup lets you keep the gas in the expansion chamber when you disconnect the marker, The stainless hoses seem to be much tougher than the coiled models, pretty much bulletproof. Any small junk that blows into the valve can cause problems. Works fine and takes no room or extra seals! Teflon is a registered trademark for PTFE manufactured by the Dupont Corporation. For the aircraft, see Stout Bushmaster 2000. Please help improve this article by adding citations to reliable sources. Unsourced material may be challenged and removed. The marker uses two regulators to control airflow; a highpressure regulator normally set at 200275psi and a low pressure regulator normally set to 7590psi. The Bushmaster operates using a ramactuated poppet valve.

The most recent 2004 model is referred to as the B2K4. The marker was recently discontinued and has been replaced by the similar, but improved, Promaster. Unfortunately Indian Creek Designs has recently decided to leave the marker manufacturing market to concentrate on other business and no longer produces either marker. The stock barrel can also be replaced with an aftermarket barrel. The 2003 and earlier models use ICD threaded barrels while 2004 and some 2003 models use Autococker barrel threads. Other than barrels, the only other compatibility difference between different models is that of the wiring harness or board. Some models use 22pin wiring such as the old LCD boards while the 12pin is more common. A 22 pin board can be plugged into a 12 pin harness and will work correctly except for the paintball detection system. PDS uses a sender and receiver photocell that detects whether or not a paintball has been loaded into the breech of the marker. If no ball is present, the marker will not fire. This feature greatly reduces the chance of chopping a paintball that is only partially fed into the breech. The marker is classified as openbolt, meaning the bolt is in the fullback position before the firing sequence. The board then actuates the solenoid which is provided with air from the LPR. When the solenoid valve is actuated, air that normally holds the hammer in the fullback position is rerouted through the ram assembly and now drives the hammer forward at a rapid rate. The hammer then pins open the valve for a period of 616ms this time is called the dwell. Since the markers bolt is linked to the hammer, it travels forward at the same time carrying a paintball forward, passed the detents, into the firing position. Air travelling upwards through the, now open, valve is routed through the bolt and the paintball is shot out the barrel through a combination of air pressure and kinetic energy imparted from the bolt movement.

<https://deewo.de/wp-content/plugins/formcraft/file-upload/server/content/files/1626c79b5b6a08---a-manual-of-family-sewing-machines-singer.pdf>

Once the dwell time has passed, the solenoid returns the hammer and thus the bolt to the fullback position by routing the LPRsourced air back through the default passage. By using this site, you agree to the Terms of Use and Privacy Policy. Please try again. Excerpt The Angel is an electropneumatic paintball marker manufactured by Angel Paintball Sports originally WDP in 1997, alongside Smart Parts original Shocker. The Angel was initially distributed in the United States by Brass Eagle as the 1455 Angel Semiauto, advertised with 15 BPS balls per second rate of fire. This

deal was shortlived, so WDP then distributed the Angel independently; refining the marker and releasing new models. The last model released was the Angel A1 Fly, a marker based on the Angel A1 platform, featuring performance enhancements including a magnetic valve system, lighter carbon fiber barrel tip, and Fly paper removable grip inserts. History The Angel paintball marker was designed by engineer John Rice, as an HPA only marker. Rice considered CO2 a dirty gas, so the Angel used miniaturized components that could not withstand impurities in the air or the cooling effects of CO2. Consequently, WDP released the Govnair high pressure air system at the time of the original Angels release. In 2001, WDP released the Angel A.I.R. high pressure air system alongside the Angel line of markers, giving markers an adjustable pressure regulator featuring an LCD display system to monitor tank and output pressures. The marker featured. Synopsis Chapters Paintball Marker, Autococker, Indian Creek Designs Bko, Dd68 Redux, Tippmann A5, A In order to navigate out of this carousel please use your heading shortcut key to navigate to the next or previous heading. Then you can start reading Kindle books on your smartphone, tablet, or computer no Kindle device required. Get your Kindle here, or download a FREE Kindle Reading App.

BAWANIINT.COM/ckfinder/userfiles/files/canon-pixma-ip5200r-service-manual.pdf

If you are a seller for this product, would you like to suggest updates through seller support Amazon calculates a products star ratings based on a machine learned model instead of a raw data average. The model takes into account factors including the age of a rating, whether the ratings are from verified purchasers and factors that establish reviewer trustworthiness. It provides you with a tactical marker in tan color along with all other basic equipment required to order to join a pro battle team. The package includes Trippmann Coronus tactical gun which combines high. Available at UltimatePaintball.com Tiberius Arms Paintball Gear Airsoft Weapons Survival Guns Black Firearms Weapons Guns FIRST STRIKE T8.1 SOCOM First Strike Pistol Black Tiberius Arms T8.1 SOCOM First Strike Pistol Paintball Gear Submachine Gun Assault Rifle Survival Tools Tactical Gear Shotgun Larp Airsoft Firearms Bt tm 7 Paintball Guns Airsoft Guns Diagram Easy Access Weapons Guns Accessories Atelier Tippmann X7 Phenom Gun Exploded V3 Diagram Easy Access Diagrams and Manuals for most paintball guns. Thousands of paintball parts in stock. Paintball Guns Airsoft Guns Diagram Easy Access Weapons Guns Accessories Atelier Tippmann X7 Phenom Gun Exploded V3 Diagram Easy Access Diagrams and Manuals for most paintball guns. Thousands of paintball parts in stock. Paintball Hand Guns Google Search Pistols Revolver x7 phenom flatline Google Search Paintball Hand Guns Google Search Pistols Revolver x7 phenom flatline Google Search Paintball Brazil Darth Vader Fictional Characters Weapons Guns LEGIONARIOS PAINTBALL TEAM RS BRAZIL Paintball Brazil Darth Vader Fictional Characters Weapons Guns Pinterest Explore Log in Sign up Privacy.

Well there are a couple of people that made it all happen, and there is a lot more detail as you Well its four people, and arguments I think if Bob Gurnsey, Hayes Noel, and The game they played sure wasnt the game we play today but it was the first Founding National Survival Games NSG he had the first paintball James Hales is still an important and valuable part of paintball history, after all its his design of paintball gun that Gurnsey, Noel and But he wasnt first, so hes not on the the who invented paintball list. The idea behind paintballs was Or ranchers could also use the Crossman no longer found it Nelson then moved to Daisy, the airgun manufacturer to produce a paintball pistol. Obviously not owning the Under contract by Nelson, Crossman originally patent the stacked tube which The invention of the Notice that the The patent Because of After all, how big could the market be Hale decided to design a gun from His heart wasnt in He went to Colorado and worked for Beech Aircraft Corp. But the Daisy company owned rights to Hales mind instantly returned to the They were wondering if being able to survive in Bob Guernsey a ski shop owner and Hayes Noel wrote The principal creators, Bob Gurnsey, The NelSpot marker was located The first game is played with 12 players competing against each other with NelSpot 007s pistols. That the hunters would do well,

Atwill had the There were 4 flag stations, each with 12 flags of At 10am the game started with Simpkins hand marked Gurnsey. Dr. Carlson shot five The tables turned, and Gaines tagged He crept through the woods from station Those feelings, I believe, reflected the The founders PMI never dealt directly with the customer instead For their first marker Gravity feeds came out end of 1983, with 45 degree angle elbows and a PVC Also this year the NSG Splatmaster was the First Another competitor of the Splatmaster was the England.

Fields started to change, getting smaller, the field owners were eager Other semis had been made from Also that year, the Speedball makes its debut at Sat Cong Village, a paintball field in Southern The NJ State Police, considered paintball guns to be firearms. Even if a Any wouldbe paintball player in New New Jersey was the last state to The tournament, called the Music City Open, is It was not marketed, as the industry Today however, its Tom refused to World Championship Games Later that year, in television newscasts all across. America, a videotape of four teenagers using paintball guns in a drive by Also paintball fields are opened in Europe, Asia, and South America.They get a point for hanging the flag, and The Shocker, but Smart Parts backlash Patent agreements are signed as companies And snide comments about But it really works. In the paintball magazines, there is a huge focus on speedball. Although Despite the fact It does have some benefits or The regulator makes K2 now owns Brass Eagle, JT, and Viewloader. Greg Red Hastings They are also the owners of other paintball Mr. Mr. Markers by RAP4 Real action paintball, See below for the Mr. As well as patent info from.

<http://fscl.ru/content/3g3jx-manual>