

# campbell hausfeld pressure washer repair manual

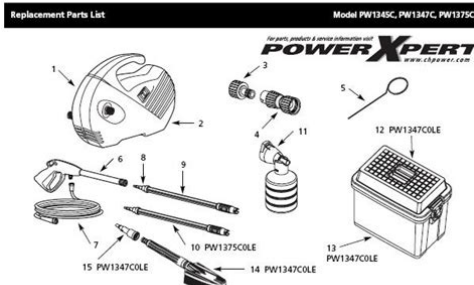

For Replacement Parts, Call 1-888-279-9274

Please provide following information:  
- Model number  
- Serial number (if any)  
- Part description and number as shown in parts list

Address parts correspondence to:  
Campbell GroupParts Department  
100 Production Drive  
Harrison, OH 45030

Ref. No.	Description	Part Number	Qty.
1	Housing Half Inlet Side	PM2372005V	1
2	Housing Half Outlet Side	PM2373005V	1
3	Nipple Adapter	PM0215004V	1
4	Quick Connect Fitting	PM0206005V	1
5	Tip Cleaner	PM0085004V	1
6	Gun	PM0372014V	1
7	Hose	PM0129004V	1
8	O-ring	PM2322005V	1
9	Adjustable Lance	PM2317005V	1
10	Turbo Lance	PM0229144V	1
11	Detergent Applicator	PM2316005V	1
12	Tool Box Lid	HV6015005V	1
13	Tool Box Tub	HV6016005V	1
14	Soft Bristle Brush	PM0202004V	1
15	Bayonet Adapter	PM0204014V	1

**File Name:** campbell hausfeld pressure washer repair manual.pdf

**Size:** 1960 KB

**Type:** PDF, ePub, eBook

**Category:** Book

**Uploaded:** 26 May 2019, 18:43 PM

**Rating:** 4.6/5 from 841 votes.

**Status:** AVAILABLE

Last checked: 4 Minutes ago!

**In order to read or download campbell hausfeld pressure washer repair manual ebook, you need to create a FREE account.**

[\*\*Download Now!\*\*](#)

eBook includes PDF, ePub and Kindle version

[Register a free 1 month Trial Account.](#)

[Download as many books as you like \(Personal use\)](#)

[Cancel the membership at any time if not satisfied.](#)

[Join Over 80000 Happy Readers](#)

## Book Descriptions:

We have made it easy for you to find a PDF Ebooks without any digging. And by having access to our ebooks online or by storing it on your computer, you have convenient answers with campbell hausfeld pressure washer repair manual . To get started finding campbell hausfeld pressure washer repair manual , you are right to find our website which has a comprehensive collection of manuals listed.

Our library is the biggest of these that have literally hundreds of thousands of different products represented.



## Book Descriptions:

# **campbell hausfeld pressure washer repair manual**

It also has a tough textured rubber outer cover, not just thermoplastic that is stiff, kinks and breaks. Just can't handle continuous use of much longer than an hour or so without letting it cool down. Great for sidewalks, patios, and bricks. Works better than new. Not a biggie and it's actually better for supply hose as the cart is moved. The pressure hose port this was an issue. My hose wouldn't fit inside the port the port wasn't large enough. I decided to drill out the port, which I did, and now it works I have the tools and knowledge to do this. What surprised me was the ease in drilling the brass fitting, until I realized it wasn't brass at all, but brass plated aluminum. Not an issue, aluminum will work just as well for my usage of the pump, but certainly was surprised I didn't even realize they made brass plated aluminum until I drilled. The mounts line. full review The upgrade in pressure was an added bonus. My old one froze and stopped pumping. Actually I can answer that too expensive. I found this one for barely over 100.00 and ordered it. I purchased it to clean my patio before I started to stain it, it worked very well. So well that I have been on a spring cleaning binge. I have been pressure washing everything my car, the stucco walls the patio and the trees. Well let me first explain you do have a strong line which gives you that strong pressure but you can also adjust it where you receive a high pressure but soft feel where it won't destroy things such as plants, stucco, car paint and so forth. I use that setting more than any other. I absolutely love it and would suggest anyone owning a home to purchase it as a must have. The outside of my house. Not a member Join today Need further assistance. Forgot username or password. Please call Member Services at 18003330663. We Are Proud To Provide Service To The Metalworking, Chip Making and Fabricating Machine Tool Manual Needs. We Have Collected These Manuals Over Many Years And Continue To Look For More Every Day. <http://www.aqualog-international.com/upload/canon-sx110-user-manual-pdf.xml>

- **campbell hausfeld pressure washer repair manual, campbell hausfeld pressure washer repair manual pdf, campbell hausfeld pressure washer repair manual instructions, campbell hausfeld pressure washer repair manual download, campbell hausfeld pressure washer repair manual transmission, campbell hausfeld pressure washer repair manual online, campbell hausfeld pressure washer repair manual tool, campbell hausfeld pressure washer repair manual diagram, campbell hausfeld pressure washer repair manual repair.**

Our Customers Have Been Pleased With Our Manuals, Schematics, Parts List, Service Manuals, Maintenance Manuals, Instructions Manuals And Brochures. They Are Filled With Invaluable Information, Sometimes Not Even Available Direct From The Manufacturer. We Are Often The Last Resort. We Take Pride In This Fact. We Are Here To Fulfill Your Industrial Machinery Manual Needs Today. Buyer relieves Industrial Manuals, of any and all claims stemming from use of our services, manuals, brochures, schematics, and Parts list. By purchasing from Industrial Manuals you agree to these terms. Buyer is responsible to contact the original manufacturer for any and all safety information. Buyer is responsible to contact O.S.H.A for all Compliances. All efforts are made to honor those materials protected under copyright. If at any time any such material is mistakenly copied and forwarded to a prospective client, the client agrees to return any and all copies to Industrial Manuals, not to produce any further copies of such material and to inform Industrial Manuals of the alleged or potential copyright infringement. Rarely does this happen that you will receive a copyrighted item. By use of our service, all users of this service agree not to copy or reproduce in any manner any of the material received from Industrial Manuals, not to rent, sell or

distribute any of the material, in any way, shape, or form. Se voce continuar a navegar o site, voce aceita o uso de cookies. Leia nosso Contrato do Usuario e nossa Politica de Privacidade. Se voce continuar a utilizar o site, voce aceita o uso de cookies. Leia nossa Politica de Privacidade e nosso Contrato do Usuario para obter mais detalhes. If you wish to opt out, please close your SlideShare account. Learn more. You must have JavaScript enabled in your browser to utilize the functionality of this website. While we will remain open for shipping, our normal business hours have changed. [http://euroquimicadistribucion.com/zabaleta/data/imagenes\\_contenidos/everflo-ef1000-manual.xml](http://euroquimicadistribucion.com/zabaleta/data/imagenes_contenidos/everflo-ef1000-manual.xml)

Please see our Contact Page for more information regarding our response to COVID19. These files download as PDFs. Repair manual for. Do not turn washer on its side or upside down to drain oil, or oil will run into carburetor. If you have problems starting read Login to post Does it sound like the engine is developing full RPM. Could be an engine problem if not coming up to full speed. Loosen and separate then check. It may also be a broken Oring. The high pressure hose connects to the high pressure outlet on the lower front of the pressure washer. Here is the operators manual that will show both connections. You would have to call their 800 number and speak with a parts person to determine availability. You may be able to purchase a close match at a local True Value hardware store. They sell a variety of brushes for many major brands of tools. Purchase a slightly larger set of brushes and sand them to size. If the connector is different, cut off the old connector and solder it to the new brush. I would suggest that you try their site and ask them to send you a PDF file on the tool. Also they have a year warranty on normal use products, so that might be an option also depending on when you bought it. Good luck and let me know if still having problems and I will try another route to help. Answer questions, earn points and help others. The motor is damaged, overloaded or overheated. The pressure washer uses high pressure water to assist in cleaning soiled exterior surfaces or machinery with little or no scrubbing by hand. If the pressure washer does not operate normally, troubleshoot it and identify the problem. Simple repairs or minor adjustments will fix most common issues. If the pressure washer does not work properly after performing troubleshooting, call for service. The pressure washer has been pressurized. Refrain from using extension cords. Unscrew the hose and remove the filter. Remove dirt and debris, replace the filter and tighten the hose.

Squeeze the trigger several times to release pressure. Turn the nozzle to the setting for a narrow stream to open the fan blades. Insert the tip cleaner included with the pressure washer into the hole on the nozzle and dislodge debris clogging the nozzle. Longer hoses decrease suction. Pressure Washers. Product Manual Model No. Serial No. For Information About This Product, call 18003300712. Model PW4035. Contents. Page. Getting to Know Your Pressure Washer..... 3. Startup, Operation, Shutdown, and Storage..... 69. Maintenance and Technical Information..... 910. Carefully read and understand these instructions. REMINDER Keep your dated proof of purchase for warranty purposes! Attach it to this manual or file it for safekeeping. Operating Instructions and Parts Manual. Frequently Asked Questions. How do I start my pressure washer? The engine does not come with oil. Set the fuel valve lever fully to the right in the "ON" position. What type of oil do I use? Engine The engine DOES NOT COME FILLED WITH OIL. See Page 10 for engine oil types and quantities. Pump. The pump comes filled with the correct amount of oil and should not need changing or filling. Refer to Pages 9 and Why don't I have any water pressure? Is the water hose attached to the pressure washer? Is the water turned on? Check for any kinks, leaks, or blockage in the hoses, fittings, or the nozzle. Is the quick connect tip in place? See Page 5 and 6. Is the inlet filter screen free of debris? Check and remove debris if needed. How do I get high pressure? Use any color tip except black. The black tip is only used for low pressure detergent application. How do I get the soap suction to work? Why doesn't the pressure washer apply detergents with high pressure? Detergents "bounce" off cleaning surfaces as fast as they are applied. The pressure washer's features allow for a detergent. By applying detergent at low pressure, the effect of "bouncing" is reduced.

Also, detergents are only effective when time is allowed for them to work on the surface of whatever is being cleaned. AfterWhat maintenance do I need to perform on my pressure washerThis will help protect the pump from damage.What do I do if I'm missing a part Call Campbell Hausfeld at 18003300712 and we will promptly replace your missing parts. Do not return the pressureWhere can I buy accessories for my pressure washer If you can't find accessories at the store where you purchased your pressure washer, call Campbell Hausfeld atWho do I call if I have questions or problems Call Campbell Hausfeld at 18003300712 U.S.A.Operating Instructions and Parts Manual. Safety and Warning Information. Safety Guidelines. This manual contains informationEQUIPMENT PROBLEMS. To helpDanger indicatesWarning indicatesCaution indicates aNotice indicatesRisk of injection orKeep clear of nozzle. Do not dischargeKeep clear of nozzle. NEVER directAlways wear safety glasses orNOTE Information that requires specialImportant Safety Instructions. Save These Instructions. California proposition 65. This product orWash hands after handling.Never try to stop or deflect leaksAlways engage the trigger safetyAlways follow detergentDo not useExplosion hazard. NEVER spray flammable liquidsDo not remove fuel tank cap orNever disconnect the high pressureNever permanently engage theNever operate the machine withoutEquipment damage.Never put hand or fingers over theOccupational Safety and Health ActALWAYS turn water supply "ON"Do not operate the pressure washerKeep screen clear of debris andNEVER operate pressure washerUse only the nozzle supplied withNever leave the wand unattendedNever tamper with the engineAlways hold gun and wand firmlyNEVER allow the unit to run withNEVER store the pressure washerFreezing temperatures can seriouslyRelease the trigger when changingFailure to do so could result inKeep hose awayBursting hoses may cause injury. ExamineDo not attempt to mend a damaged hose. Unpacking.

Remove the equipment and all parts fromOne pressure washer pump, engine,One cart handle assembly. One spray gun and quick connectFive spray tips. One high pressure hoseIf any parts are missing, DO NOTAfter unpacking the product, inspect itMake sure toDo not operate theDamage could result in bursting andFigure 3 Insert spray tips into theFigure 4. Assembly. Chemical Injector. Hose Barb. High Pressure. HoseSee Figure 1. Outlet. Star. Knob. Thermal. ReliefPump. Inlet. Garden Hose. Figure 4 Pump hook upOperating Instructions and Parts Manual. PreOperation ContinuedTrigger safety latch. In the engaged position, the triggerPush the latch fullyAlways engage the trigger safety latchEngaged. Disengaged. Figure 8 Trigger locked. Figure 9 Trigger unlockedNever run theFigure 7 Quick Connect Tip. OperationThe following cleaning procedure willBefore starting a pressure washerAlso, protect allALWAYS use the following start upIf water has frozenDO NOT pourDO NOT refuel a hotClose the fuel shutoff valve duringClose the choke if the engine is coldSome local plumbingInstall a backflowNOTE The inlet water supply must haveWhen pulling theNever let the starterDoing so could jam the recoil system. Pressure Adjustment. Please refer to your CAT pump manualAdjusting the spray fan angle. Five quick connect tips are included withThe tips have aPressure can also be adjusted by movingHow to avoid damaging surfacesSteps 7 and 8 until the engine starts.Spray the cleaning surface with water toDoing so allowsAfter the engine starts, trigger the gunCounterclockwise. Lower pressure. Clockwise. Higher pressure. Figure 11 Camshaft pump pressureFigure 14 Optimum angle to cleaningFigure 12 Narrow high impact stream. Figure 13 Wide fan pattern. Angle to the cleaning surface.

When spraying water against a surface,The optimum angle for spraying waterSpray water against a surface at aDamage to cleaning surfaces occursYou can vary the impact force byAvoid sprayingThe most sure way to avoid damagingTrigger the gun.Distance from cleaning surface. The distance between the spray tip andThe impact force of the water increasesOperating Instructions and Parts Manual. Operation ContinuedNote Use only detergents formulatedThe use of detergents can dramaticallyPressure washer detergents are as thick asOnce applied to a cleaning surface,You can effectively clean surfaces byTurning collar clockwise increasesGeneral Cleaning TipsNEVER replaceAlways engageThe easiest way to regulate the cleaningSlowly move closerNote The unit also

has a pressureThe final rinse should start at the bottomTo reduce the risk of bodily injury orNEVER  
turn theSerious damage could occur to the pump. NEVER disconnectDo not store the pressure  
washerDo not store the pressure washerNever pull theFuel vapor from the hole can ignite by aRead  
theWinterizing instructionsStorage Instructions above.Running the unit without sprayingHold the  
gun and lance in a verticalMaintenance. Observe regular maintenance intervals toRefer to theIf you  
operate the pressure washer inPlease refer to provided AR Pump. Specification page provided with  
your. Pressure Washer for details.Before tipping theNote Change oil while the engine isOil Fill. Oil  
DrainFigure 15 Oil drain and fill locationsOperating Instructions and Parts Manual. Maintenance  
Continued. Maintenance Schedule. Technical and Consumer Information. Action Needed. Horizontal  
Oriented Pressure Washers. Daily. Check water inlet screen andEngine Oil Type. Check engine oil  
levels. Fill asAfter first 5 hours ofEvery 25 hours ofCheck gasoline level. Fill asChange engine  
breakinHonda Owner's Manual forEngine Oil Capacity. Honda GX390. Pump Oil Type. Change oil.  
Replace spark plug. Each 100 hours ofReplace paper air cleanerChange engine oil.

AR PumpsPump Detergent Suction. Water to detergent ratio. Clean or replace paper airEngine Fuel  
Capacity. Change oil if operatingEvery 50 hours ofManualWater Supply Requirements. Minimum  
inlet pressure. Maximum inlet pressure. Maximum inlet temperature. Minimum inlet flow rate. Inlet  
garden hose size. Maximum inlet garden hoseService Record. DateMaintenance performed.  
Replacement components requiredPlease provide following informationCampbell Hausfeld. Attn  
Customer ServiceHarrison, OH 45030 U.S.A.Ref. No. DescriptionHandle assembly. ISO mount  
assembly. Pneumatic wheel. Carriage bolt. Star knob. Palnut. Rubber grommet. Plug. Gun. Gun  
oring. Gun backup oring. Lance. High pressure hose. Pump Assembly. Engine. Socket Quick connect.  
Plug Quick connectDetergent BlackStandard hardware itemQty.Troubleshooting Chart Gasoline  
Powered Pressure Washers Only. Symptom. Engine will not start orPossible Causes. Corrective  
ActionCheck fuel line and carburetorUse new fuel and dryEngine misses or lacksSee service  
centerCheck inlet water flowWater leakage fromWorn water seals. Install new water seals. See  
service center. Water in pumpSee service center. Frequent or prematureSee service centerForeign  
particles in the inlet orClean or replace valves. Strong surging at theSee service center. Fluctuating  
pressurePurge air fromPressure drops afterSymptom. Possible Causes. Corrective ActionIncrease  
water pressurePressure washer will notIf detergent is dispensedClean the barb,NotesOperating  
Instructions and Parts Manual. Limited WarrantyOH 45030, Telephone 18003300712.Hausfeld  
pressure washer.C. Any failure that results from shipping damage, accident, purchaser's abuse,  
neglect or failure to install and operateD. Predelivery service, i.e. assembly, oil or lubricants and  
adjustment. E. Items or service normally required to maintain the pressure washer. F. Gasoline  
engine and components are expressly excluded from coverage under this limited warranty. Such  
componentsG.

High Pressure Pump and components are expressly excluded from coverage under this limited  
warranty. AR North. America should be contacted for information on authorized repair stations for  
service or replacement. AR North. America may be contacted at [www.arnorthamerica.com](http://www.arnorthamerica.com) or  
18008934235, extension 217. H. Additional items not covered under the warrantyB. Deliver or ship  
the Campbell Hausfeld pressure washer or component to nearest Campbell Hausfeld Authorized  
Service. Center. Freight costs, if any, must be borne by the purchaser. C. Use reasonable care in the  
operation and maintenance of the pressure washer as described in the owner's manuals.This Limited  
Warranty applies in the U.S., Canada and Mexico only and gives you specific legal rights. You may  
also have otherManuel de Instrucciones y Lista de PiezasModelo PW4035. Ensamblaje y Previo al  
Funcionamiento..... 19 20. Encendido, Funcionamiento, Apagado y Almacenamiento.....  
20 23. Lea cuidadosamente y entienda estas instruccionesManuel de Instrucciones y Lista de Piezas.  
Preguntas FrecuentesAbra el pase de agua, luego presione el gatillo de la pistola para asegurarse de  
que el agua fluya con facilidad desdeMueva la toma de aire completamente a la izquierda. Motor El  
motor SE ENTREGA SIN ACEITE. Bomba La bomba se entrega con la cantidad correcta de aceite y

no debe necesitar cambios o cantidades adicionales. Verifique que no haya codos o obstrucciones en las mangueras, los acoples o en la boquilla. Verifique y quite los residuos si es necesario. Use cualquier boquilla de color menos la negra. Los detergentes "resbalan" de las superficies de limpieza tan pronto como se apliquen. Llame a Campbell Hausfeld al 18003300712 U.S.A. Manuel de Instrucciones y Lista de Piezas Peligro indica una Advertencia indica Aviso indica instrucciones de seguridad Guarde estas instrucciones.

Cuando use este producto, siempre se Ley de salud y seguridad ocupacional Este producto, o Use siempre gafas de seguridad y Nunca coloque la mano ni los dedos Nunca intente detener ni desviar las. Siempre enganche el pasador de Siempre siga las recomendaciones No ejerza Peligro de No quite la tapa del tanque de Nunca desconecte la manguera de Nunca enganche el mecanismo del SIEMPRE encienda el suministro de No ponga en funcionamiento la Mantenga la rejilla libre de residuos y NUNCA opere la lavadora a No altere nunca el regulador del Siempre sostenga la pistola y la varilla. NUNCA permita que la unidad Suelte el gatillo cuando cambia de Mantenga la Examine las mangueras regularmente Retire el equipo y todas las piezas de la caja. La caja debe contener lo siguiente Si faltara cualquier pieza, NO DEVUELVA. LA UNIDAD AL COMERCIANTE. Conozca el Figura 6. No haga funcionar Utilice la perilla estrella y el perno para Figura 5 Conecte la manguera de alta Empalme para el. Manguera de. Perilla Salida Entrada de la Manuel de Instrucciones y Lista de Piezas. Pre Funcionamiento Funcionamiento Seguro del gatillo Trabado. Sin trabar No haga funcionar Funcionamiento. El siguiente procedimiento de limpieza lo Antes de empezar su trabajo de limpieza SIEMPRE use este procedimiento de Si el agua se ha Agregue aceite si es necesario. NO llene el tanque NOTA El suministro de agua en entrada Figura 10 Obturador Cuando hale del No deje nunca que Girar a la izquierda. Girar a la derecha. La distancia entra la superficie y la boquilla Distancia de la superficie a Cuando pulverice agua contra una Sin embargo, este tipo de impacto puede Pulverice agua contra una superficie a 45 Evite rociar las ventanas con un chorro Hacer esto puede Manuel de Instrucciones y Lista de Piezas Una vez aplicados a la superficie de Puede limpiar eficazmente las superficies.

En superficies verticales, aplique el Consejos generales de limpieza Espere un par de minutos para que el Nunca deje secar el detergente sobre la Nunca reemplace Siempre trabe Para reducir el riesgo de lesiones personales Apague la unidad. Cierre el suministro de agua. Suelte el seguro del gatillo y presione NUNCA cierre el sum NUNCA desconecte Para despresurizar, apague el motor, Instrucciones para la Lea las instrucciones Mantenimiento. Observe los intervalos regulares del Llenado Drenaje Figura 15 Puntos de drenaje y llenado Manuel de Instrucciones y Lista de Piezas. Programa de mantenimiento. Programa de Tipo de aceite para el motor. A diario. Verificar la rejilla y el filtro de Verificar los niveles de aceite Capacidad del aceite para el Verificar el nivel de gasolina. Cambiar el aceite de ablande Cada 25 horas de Honda GX390. Cambiar el aceite. Cada 100 horas de Reemplazar el cartucho de Cambiar el aceite del motor. Tipo de aceite para la bomba. Capacidad de aceite de la AR Pumps Requisitos del suministro de Registro de servicio. Fecha Limpiar o reemplazar el Capacidad de combustible del Cada 50 horas de Repuestos requeridos Campbell Hausfeld. Attn Customer Service Harrison, OH 45030 U.S.A. Ensamble del mango. Ensamble del montaje ISO. Perno del carro. Perilla estrella. Contratuerca. Ojal de goma. Pistola. Anillo O de pistola. Anillo O de respaldo para pistola. Lanza. Ensamble de la bomba. Motor Detergente negro Nota Para mantenimiento del motor o repuestos, llame a Honda al 18004267701 Ctd. El motor no arranca o Causas posibles Llene si fuese necesario El motor pierde o no Reemplace los sellos de agua. Consulte al centro de servicio Verifique el caudal de Instale nuevos sellos de agua. Consulte al centro de Consulte al centro de Falla frecuente o Consulte al centro de servicio Consulte al centro de Reemplace los sellos de aceite o los anillos O. Consulte al Sellos o anillo O del aceite gastados Notes Si se pasa detergente a Manuel de Instrucciones y Lista de Piezas. Campbell Hausfeld. En algunos estados no se D.

El servicio al producto antes de la venta. Ejemplo ensamblaje, aceites o lubricantes, ajustes, etc.A.  
Proporcionar prueba de la fecha de compra y registros de mantenimiento.IN626701AV Operating  
instructions.